

FAG

2206-K-2RS-TVH-C3

Self-aligning ball bearing

Schaeffler ID:
0384725620030Self-aligning ball bearing 22..-K-2RS-TVH,
tapered bore taper 1:12, seals, plastic
cage

Technical information

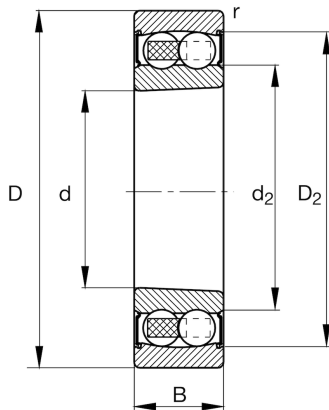

Main Dimensions & Performance Data

d	30 mm	Bore diameter
D	62 mm	Outside diameter
B	20 mm	Width
r_{\min}	1 mm	Minimum chamfer dimension
C_r	15.900 N	Basic dynamic load rating, radial
C_{0r}	4.650 N	Basic static load rating, radial
C_{ur}	295 N	Fatigue load limit, radial
n_G	6.800 1/min	Limiting speed
	0,26 kg	Weight

Dimensions

D_2	53,3 mm	Caliber diameter outer ring
d_2	37,3 mm	Caliber diameter inner ring

Mounting dimensions

$d_{a\min}$	35,6 mm	Minimum diameter shaft shoulder
$d_{a\max}$	38 mm	Maximum diameter shaft shoulder
$D_{a\max}$	56,4 mm	Maximum diameter of housing shoulder
$d_{b\min}$	33 mm	Minimum cavity diameter of the sleeve
$B_{a\min}$	5 mm	Minimum cavity width of the sleeve
$r_{a\max}$	1 mm	Maximum fillet radius

Calculation factors

e	0,25	Limiting value of F_a/F_r for the applicability of diff. Values of factors X and Y
Y_1	2,54	Dynamic axial load factor
Y_2	3,93	Dynamic axial load factor
Y_0	2,66	Static axial load factor

Additional information

H306	Adapter sleeve
------	----------------

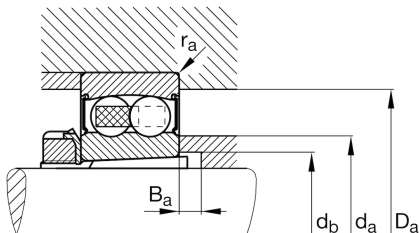
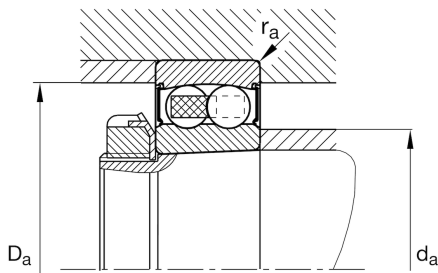

Temperature range

T _{min}	-20 °C	Operating temperature min.
T _{max}	100 °C	Operating temperature max.